



## What is Recyclable with Helena Recycling?

Please sort into four bins: **MIXED RECYCLABLES WILL NOT BE PICKED UP!**

**Yes!**

### Paper Bin

**No**

Newspapers/inserts, magazines, home office paper (white/pastel), BAGGED shredded paper, copy/fax paper, post-it-notes, white envelopes, and paper ream wrappers.



Tissues/tissue paper, food wrappings, paper towel, soiled/food stained paper, hard back book bindings, construction paper, wrapping paper and dark colored office paper, phone books, manila envelopes and file folders.



We do accept thin cardboard, paper bags and packaging, but **PLEASE PLACE WITH CARDBOARD.**



*Do NOT include with paper.*

**Yes!**

### Metal Bin

**No**

Aluminum cans and steel/tin cans.



Bottle caps, aerosol cans, paint/solvent containers, tin foil/pans and scrap metal.

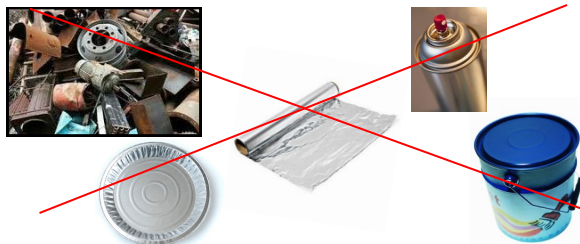

**Yes!**

### Plastics Bin

**No**

**All Type 1 and Type 2 plastic:**  
Containers accepted: plastic bottles, milk jugs, pop/water/juice bottles, laundry detergent bottles. **Make sure it has a recycling symbol with a 1 or 2. Remove lids!**



**Type 3-7 plastics** like butter and yogurt containers. Plastic caps or lids. No styrofoam. Plastic bags, wrappers, zip lock bags, bread bags, etc. **No bags of any kind.**



## Cardboard

Flatten and place cardboard in another box/container (see picture below).

**Yes!**

Moving/mailling boxes, non-corrugated (like cereal boxes), brown paper bags and packaging, and any thin cardboard.

**Must be flattened!**



**No**

Soiled cardboard (i.e. oily pizza boxes), egg cartons, milk cartons, and paper cups.



## Glass

Glass containers (all colors), bottles, and jars.

**Remove lids!**

**Only ONE bin of glass per pick-up.**



## Policy Reminders — PLEASE READ!

- Rinse out ALL recycled containers.
- Flatten ALL cardboard boxes — cardboard not broken down will not be taken.
- Keep bins stored indoors until pick-up day to preserve their condition.
- No small bags filled with recyclables.
- No plastic bags of any kind.
- Absolutely NO trash.

**Please put your bins out the night before your scheduled pick-up day.**

Contact us if you have any questions:

Helena Recycling, LLC

PO Box 6020

Helena, MT 59604

**406-457-2437**

[gogreen@helenarecycling.com](mailto:gogreen@helenarecycling.com)

[www.helenarecycling.com](http://www.helenarecycling.com)

